



Repair Instructions for LNG Female Quick Disconnect Vents with Repair Kit p/n 11175-2

Macro Technologies, LLC



REPAIR INSTRUCTIONS
Read all instructions thoroughly *before* repairing the Macro Technologies LNG Female QDV (part numbers: 11175, 13775, 13785). **Remove QDV from LNG dispenser before repairing.**

TOOLS AND PARTS (sold separately)

SOCKET TOOL #T-1948



REPAIR KIT #11175-2 INCLUDING PARTS:

11157 Poppet Assembly



11172 Seal

11093 Seal Assembly



You will also need: a torque wrench with 1" socket, an open ended wrench and open ended torque wrench with 1.5" capacity, and a vise.



Replace Seal Assembly

Step 1A: Insert tool T-1948 into torque wrench and secure QDV in a vise.

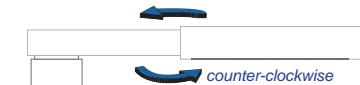
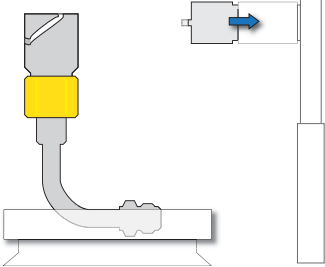

Step 1B: Insert torque wrench and tool T-1948 into QDV Female Housing, making sure that the flat on tool T-1948 aligns with slots in QDV seal retainer.
Turn torque wrench counter-clockwise to unscrew the seal retainer.

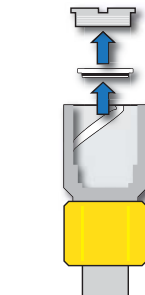

Step 1C: Remove QDV seal retainer and Seal Assembly.



Step 1D: Seat new Seal Assembly p/n 11093, open side down

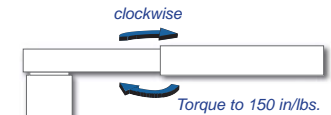

Step 1D: Replace seal retainer and tighten by turning clockwise and torquing to 150 in/lbs.

Replace Poppet Assembly and Seal

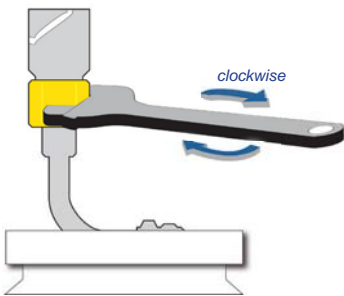

Step 2A: Remove brass nut using open ended wrench and turning clockwise.

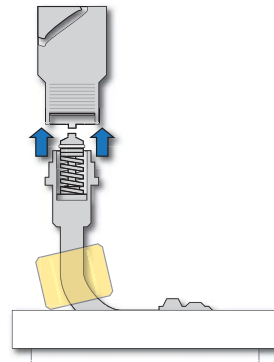

Step 2B: Separate QDV Female Housing from QDV body.

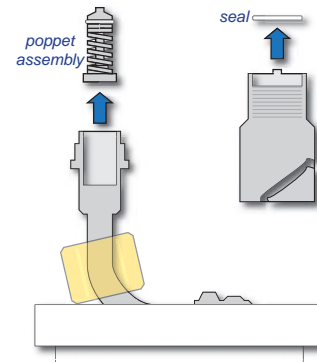

Step 2B: Remove old Seal from QDV Female Housing and remove old Poppet Assembly from QDV body.

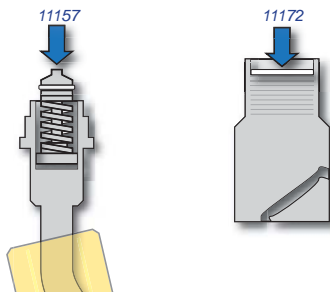

Step 2C: Seat new Poppet Assembly (p/n 11157) in QDV body and seat new Seal (p/n 11172) in QDV Female Housing.

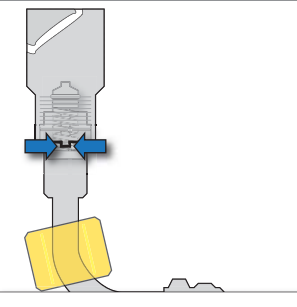

Step 2D: Realign QDV Female Housing with QDV body, ensuring "Posilok" anti-rotation tangs on QDV Female Housing align with recessed grooves of QDV body.

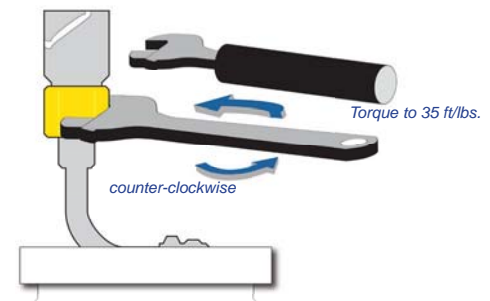

Step 2E: Thread brass nut back onto QDV Female housing and body, turning counter-clockwise with open ended torque wrench. Torque to 35 ft/lbs. with open ended torque wrench.



For part drawings and more information please visit www.macrotechnologies.com
or call us at +1 425-825-8100 for engineering assistance